

PORODO



Porodo

5-In-1 Hot Air Brush Styling Set

SKU: PDLFST56

Table of Contents

Preface	2
Safety Instructions	2
Important Notes	4
Product Overview	5
Switching On	6
Switching Off	6
Instructions for Use	6
Cleaning Guide	7
Troubleshooting	7
Specifications	7
Environmental Protection	8
Warranty	9
Contact Us	9

Preface

Thank you for the purchase of the Porodo 5-In-1 Hot Air Brush Styling Set. It is recommended that these instructions be carefully read to become familiar with the unit's features and to ensure optimal use of the product.

Safety Notice: The safety of the user and others is of utmost importance. It is essential that the safety instructions be thoroughly reviewed before the hot air styler is operated.

Safety Instructions

All safety instructions must be read before the first use of the hot air styler.

WARNING: The appliance must be disconnected from the power supply before any maintenance or adjustment. To avoid the risk of electric shock:



WARNING: This appliance should not be used near bathtubs, showers, basins, or other vessels containing water.

WARNING: The appliance should not be used near water.

1. The airborne noise emitted by the appliance is ≤ 90 dB(A).
2. When used in a bathroom, the appliance must be unplugged after use, as proximity to water presents a hazard, even when the unit is switched off.
3. For additional protection, the installation of a residual current device (RCD) with a rated residual operating current not exceeding 30 mA is recommended for the electrical circuit supplying the bathroom. Professional advice from an installer should be sought.
4. This appliance may be used by children aged 8 years and above, and persons with reduced physical, sensory, or mental capabilities, or lack of experience and knowledge, provided that they have received supervision or instruction on the safe use of the appliance and understand the hazards involved. Children must not play with the appliance. Cleaning and user maintenance must not be performed by children without supervision.

- 5.** Children should be supervised to ensure they do not play with the appliance.
- 6.** If the supply cord is damaged, it must be replaced by the manufacturer, a service agent, or similarly qualified persons to avoid a hazard.
- 7.** The appliance must always be unplugged after use.
- 8.** The appliance should not be used or stored in areas where it may come into contact with water.
- 9.** The appliance must never be left unattended while plugged in.
- 10.** The power cord should not be pulled or wrapped around the hot air styler.
- 11.** Close supervision is necessary when the appliance is used by, on, or near children.
- 12.** Only attachments recommended by the manufacturer should be used.
- 13.** The hot air styler should not be operated if the cord or plug is damaged, or if the appliance has been dropped into water. It must be returned to a service center for inspection and repair.
- 14.** The power cord must be kept away from heated surfaces.
- 15.** The air vents at the rear of the hot air styler must not be blocked, and it should not be placed on a soft surface that could obstruct airflow. The air vents must be kept free of dust, hair, and other debris. No objects should be inserted into the air vents.
- 16.** The appliance must not be used outdoors or in areas where aerosol products are in use.
- 17.** The hot air must not be directed toward the eyes.
- 18.** Attachments may become hot during use. Caution should be exercised when handling them.
- 19.** The appliance should not be placed down while it is operating.
- 20.** The voltage rating of the appliance must be checked to ensure it matches the supply voltage.
- 21.** If the appliance falls into water, it must be unplugged immediately. Do not reach into the water until the power has been disconnected.
- 22.** The appliance should not be used if the power cord is damaged. It must be replaced by the manufacturer, an aftermarket service provider, or a sufficiently qualified person to prevent any risk of accident.

23. This appliance should not be used by children under the age of 8. It may be used by children aged 8 years and above, and persons with reduced physical, sensory, or mental capabilities, or lack of experience and knowledge, if they have been given supervision or instruction regarding the safe use of the appliance and understand the associated hazards. Cleaning and user maintenance should not be performed by children without supervision.

Important Notes

The mains lead of this appliance is not replaceable by the user. If the supply cord is damaged, it must be replaced by the manufacturer, its service agent, or similarly qualified persons to prevent any hazards.

1. Safety Considerations: Ensure that the power supply lead is positioned in a way that it will not be walked on or pinched by items placed on or against it. Do not use the hot air styler in humid or damp conditions. Avoid allowing the appliance to get wet, such as through dripping or splashing, as this may pose a danger.

2. Ventilation: The slots and openings on the appliance are for ventilation. They must not be covered or blocked, as this could result in overheating. NEVER allow children to insert objects into the holes or slots of the hot air styler.



Product Overview

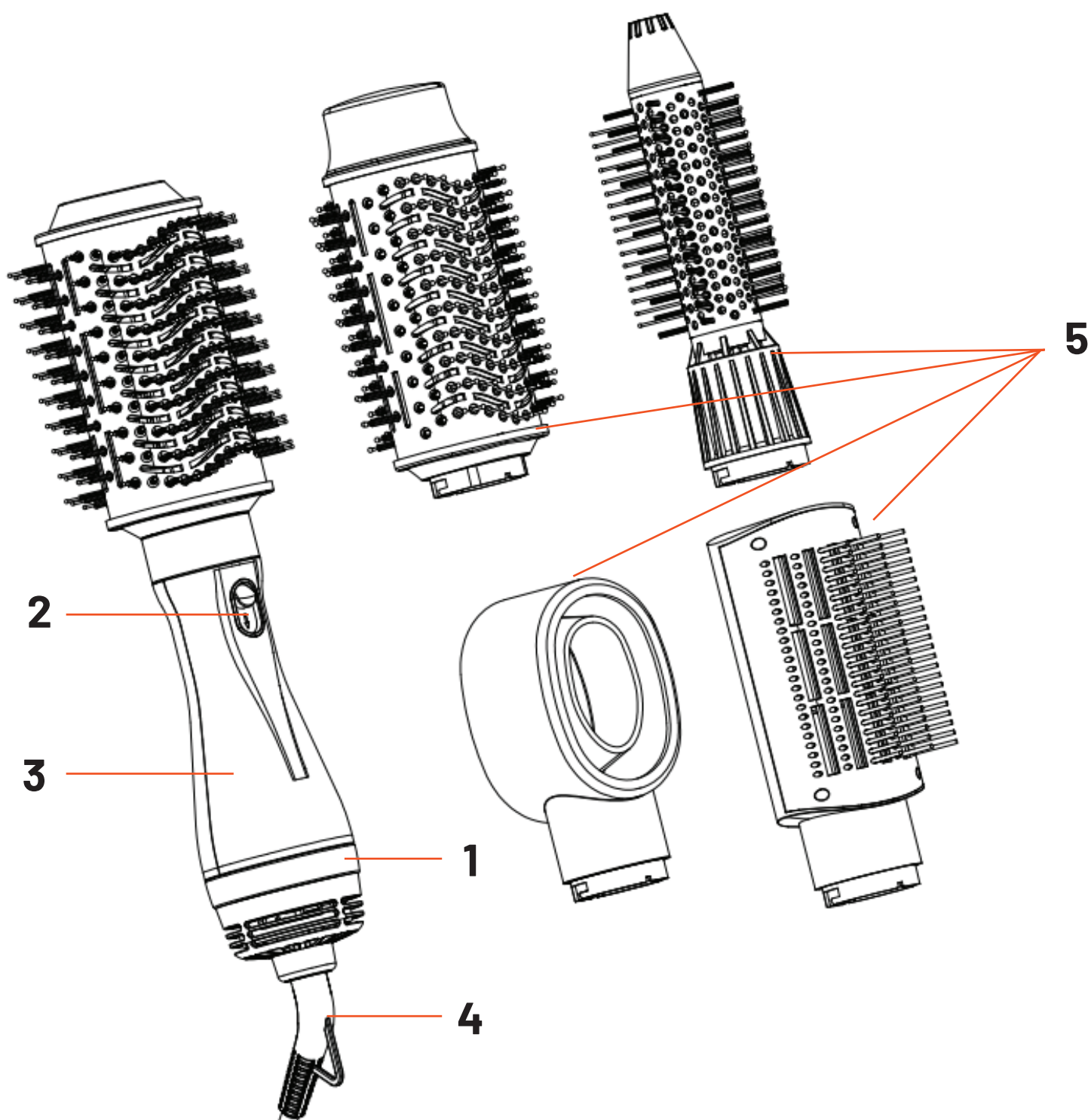

1. O-C-I-II Switch

2. Lock button

3. Handle

4. Power cord

Switching On

1. Unwind the power cable, plug it into the mains socket, and switch on.
2. Set the On/Off switch to the desired setting (1 or 2).
3. Position 2 provides more heat than position 1.

Switching Off

After use, set the On/Off switch to the off (0) position.

Instructions for Use

1. Shampoo and condition your hair. Rinse thoroughly and towel blot to remove excess moisture.
2. Divide your hair into sections. Using the hot air styler along with a styling brush, direct hot air through each section.
3. Move the dryer steadily across each section to ensure even airflow through the hair, avoiding direct airflow on the scalp.
4. Keep the dryer's air intake vents unobstructed and free from hair during use.
5. To prevent over-drying, do not concentrate heat on any one section for too long. Keep the dryer moving while styling.
6. For quick styling, lightly mist hair with water before using the dryer.
7. When creating curls or waves, dry hair almost completely on the highest heat setting, then finish styling using the lower setting. This will help set the style.
8. The dryer includes a concentrator attachment. Use it to focus drying power on small areas (such as curls or waves) or to relax curly hair.

Important: Before performing any of the following actions, ensure that the hot air styler is unplugged from the mains supply.

Cleaning Guide

1. Do not use liquid or aerosol cleaners.
2. Clean the appliance with a soft, damp (not wet) cloth.

Troubleshooting

The Hot Air Styler Does Not Work:

1. Ensure that the appliance is properly plugged into the mains supply and that the power is switched on.
2. Confirm that the ON/OFF button is in the "on" position.
3. Check the fuse in the plug and refer to the Electrical Information section for guidance.
4. If the appliance continues to malfunction, please contact an authorized service agent for further assistance.

Specifications

Rated Voltage	220-240V
Rated Frequency	50/60Hz
Rated Power	1000W
Wind Speed	3 Settings
Noise Level	3 Settings

Motor Speed	29500±10% ,19400±10% ,29700±10%rpm
Power Cord	UK 3-Pin Plug
Temperature Control	3 Settings
Cord Length	1.8m
Model Number	PDLFST56

Environmental Protection



This marking indicates that the product should not be disposed of with other household waste within the EU. To prevent potential harm to the environment or human health from uncontrolled waste disposal, please recycle the product responsibly to promote the sustainable reuse of material resources.

To dispose of your used device, please utilize the return and collection systems or contact the retailer from whom the product was purchased. They can ensure the product is recycled in an environmentally safe manner.

Warranty

Products that you buy directly from our **Porodo** website or shop come with a 24-month warranty.

When you buy **Porodo** products from any of our approved sellers, you only get a 12-month warranty. If you want to extend this warranty, go to our website at **porodo.net/warranty** and fill out the form with your information. Don't forget to upload a picture of the product too. After we've checked and accepted your request, we'll send you an email to confirm that your product's warranty has been extended.

For more info, please check:
porodo.net/warranty

Contact Us

If you have any questions about this Privacy Policy, please contact us at:
info@porodo.net

Website: **porodo.net**

Service Support: **support@porodo.net**

Instagram: **porodo**